

Compact, two-way passive cabinet. Consists of a 12" (3" voice coil) LF transducer and a 1" HF driver mounted on a 90° x 60° rotatable horn.



### Key features

- Compact two-way passive cabinet
- 90° x 60° rotatable horn
- Screwless grill with protective acoustic textile
- Integrated ergonomic handle
- Hidden speakon connection
- Polyurea coating

### Applications

- Club & bar installations
- KTV & Karaoke Rooms
- Houses of worship
- Public address
- Sound reinforcement
- Multi media spaces

### General description & specifications

The KR-12 is a compact, two-way passive cabinet. Consists of a 12" (3" voice coil) LF transducer and a 1" HF driver mounted on a 90° x 60° rotatable horn offering a wide range of applications for fixed installations.

It has been specially designed as a club system for entertainment, such as KTV and karaoke rooms, with high vocal coherence and a stable sound pressure level.

The 12" driver offers high power handling and high sensitivity with low harmonic distortion and linear response. The cone is waterproof

and has been treated on both sides. The ultra-compact 1" HF driver achieves high sensitivity, with exceptional dynamic range creating remarkable depth and definition.

Constructed from MDF and coated in high resistant polyurea paint. The enclosure also offers a screw free grille together with a number of dedicated accessories. Although the KR-12 can be used without a processor, we recommend that the cabinet presets are applied for maximum optimization and performance.

### Technical Data

<b>Components</b>	
• LF	12" speaker, 3" (75 mm) copper wire voice coil, waterproof cone with treatment on both sides
• HF	1" exit throat (38 mm) voice coil, BMS annular diaphragm driver
<b>Frequency range</b>	58 Hz – 22 KHz (-10dB)
<b>Sensitivity</b>	97 dB
<b>Max SPL / Peak SPL*</b>	124 dB / 130 dB peak
<b>Rated power</b>	500 W AES (1000 W program, 2000 W peak)
<b>Dispersion</b>	90° x 60° rotatable
<b>Nominal impedance</b>	8 Ω
<b>Connectors</b>	2 x Neutrik Speakon NL4MP
<b>Finish</b>	Polyurea coating
<b>Material</b>	15 mm Premium MDF
<b>Dimensions</b>	600 x 363 x 410 mm (H x W x D)
<b>Weight</b>	24 Kg (52.9 lbs)
<b>Fittings</b>	14 x M8, ergonomic handle on the back position, 4 x M6 U-bracket, 6 x M6 wall bracket, 35 mm top hat
<b>Accessories</b>	U bracket horizontal & vertical, M8 eyebolts, wall bracket

\* Calculated maximum SPL based on rated peak power and measured sensitivity.

### Frequency response

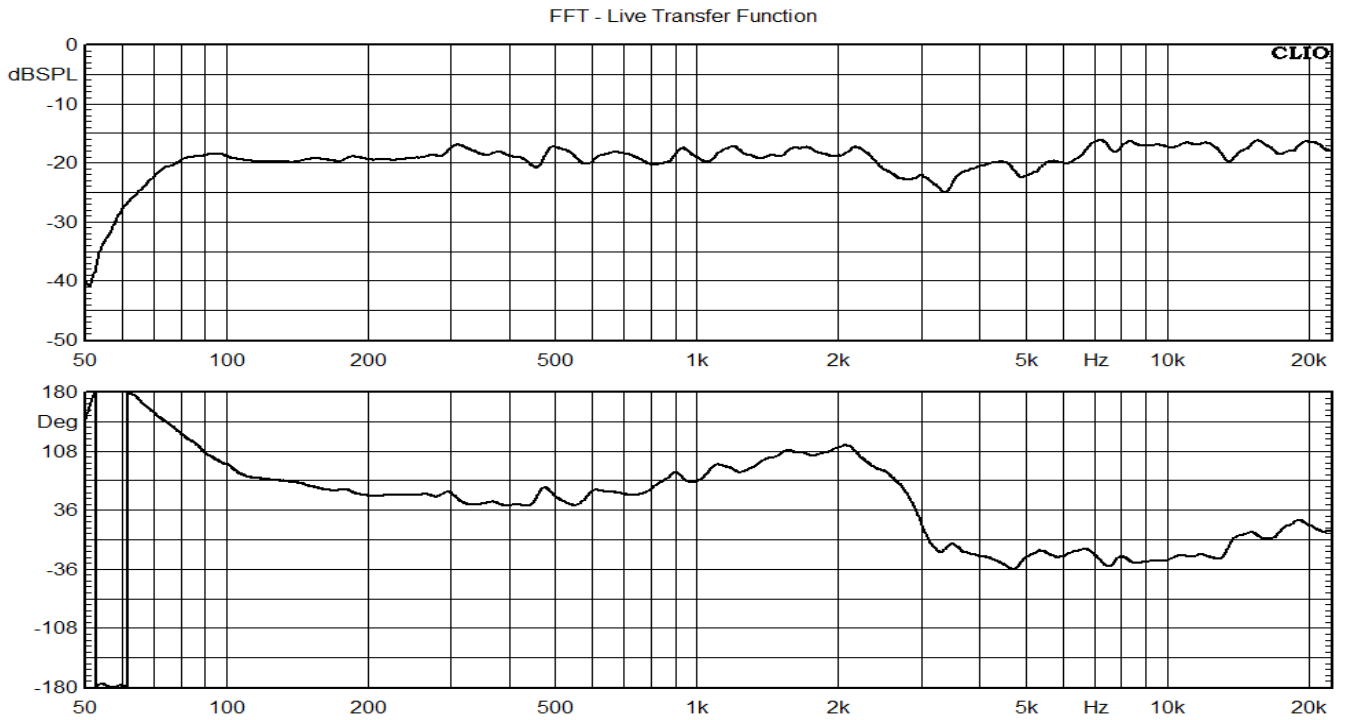

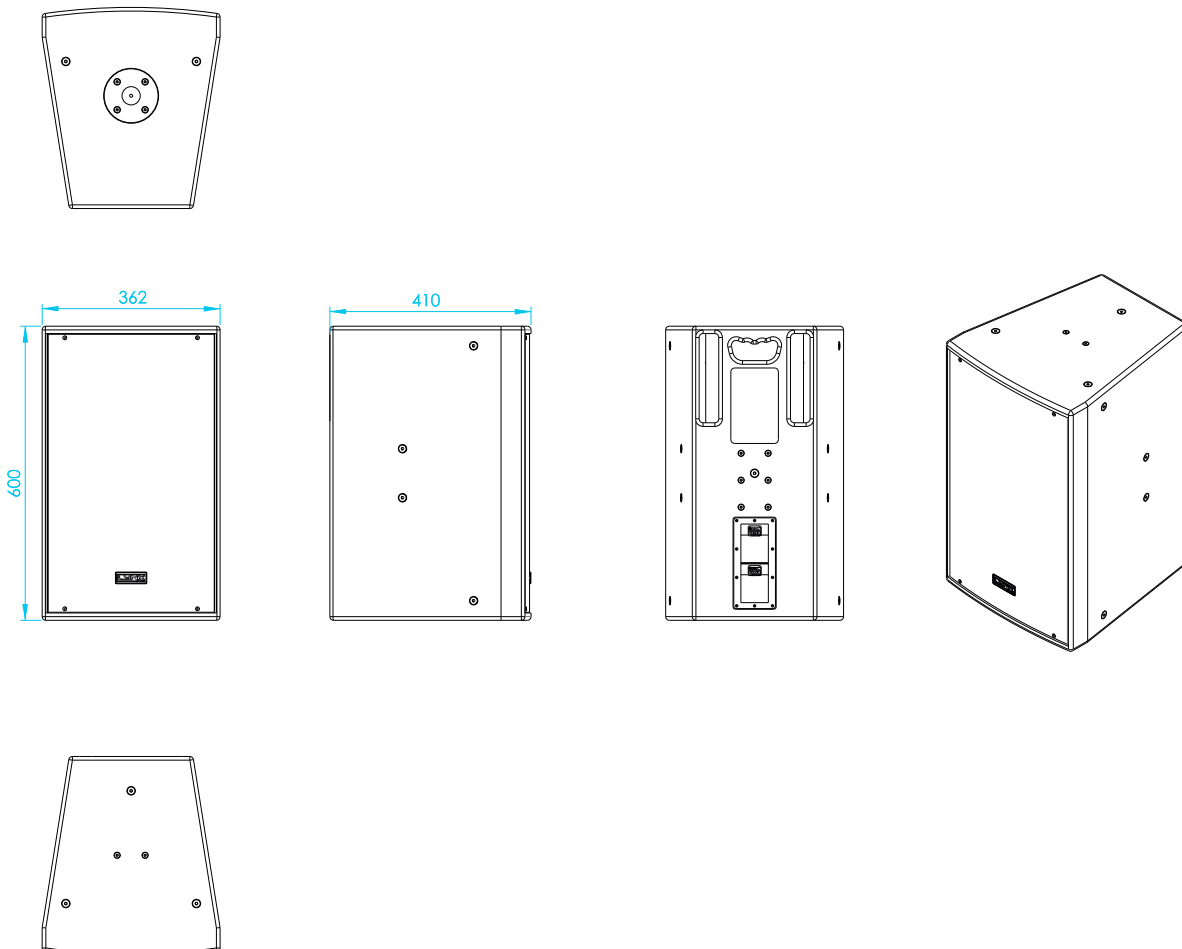

### Dimensional Drawing

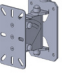

## Accessories

---

	AGR-8	M8 Eyebolt
	WB-20/3	Wall bracket for KR-12
	UBR-KR12	U bracket for KR-12